

CITY OF COUNCIL BLUFFS - CITY PLANNING COMMISSION

CASE #SAV-18-014 STREET/ALLEY/ROW VACATION MAP

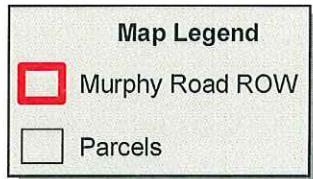

0 200 400
1 Inch = 400 Feet

2016 Aerial Photograph



Note: Subject properties are highlighted in red.



Last Amended: 10/22/18



Council Bluffs Community
Development Department
209 Pearl Street
Council Bluffs, IA 51503
Telephone: (712) 328.4629

DISCLAIMER
This map is prepared and compiled from
City documents, plans and other public
records data. Users of this map are
hereby notified that the City expressly
disclaims any and all responsibility for errors,
if any, in the information contained on this
map, the reliance of the user by the user
or anyone else. The user should verify the
accuracy of information/data contained on
this map before using it. The City assumes
no legal responsibility for the information
contained on this map.

